

Multilink® Automix

Placement of indirect composite restorations
(Inlays, onlays, crowns)

Befestigung von indirekten Composite-Restaurationen
(Inlays, Onlays, Kronen)



Restoration Restauration

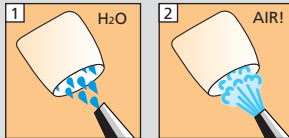

Pre-treatment of composite restorations:

Roughen with a finishing diamond 25 µm

Vorbehandlung für Composite:

Anrauchen mit Finierdiamanten 25µm

Monobond-S

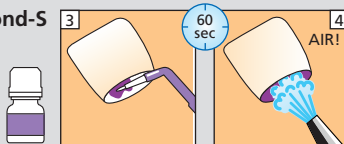

Dentin/Enamel Dentin/Schmelz

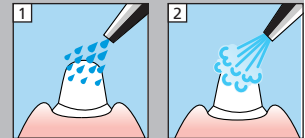

Mix Multilink
Primer A+B 1:1

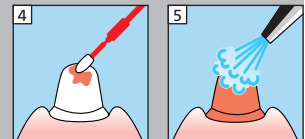
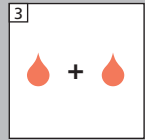

15 sec application 15 Sek. applizieren

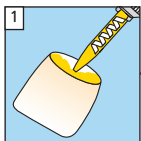

1
Apply on restoration
Auftragen auf
Restauration

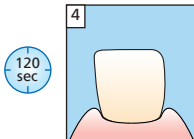
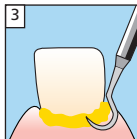
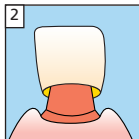
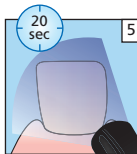
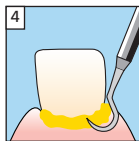
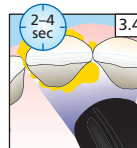
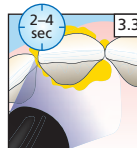
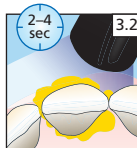
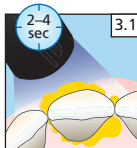
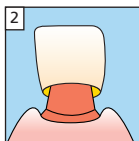

Remove excess immediately!
Überschüsse sofort entfernen!

CE 0123

Please read Instructions for Use
Bitte lesen Sie die Gebrauchsinformation

ivoclar
vivadent
clinical

616360/1108/4/e/BVD